

HHC41-6-1ZF/HF Industry Control Relay 工业控制继电器

(Application 应用: PLC, Elevator 电梯, industrial device 工控设备, Lamp 灯, PV inverter 逆变器, UPS, Charging 充电, DCS, Smart home appliance 智能家电)

 <p>The image shows two views of the HHC41-6-1ZF/HF relay. The top view is a perspective shot of a white plastic relay with a label that reads 'C-Lin HHC41-6-1ZF DC24V 6A/250VAC 6A/30VDC KS'. The bottom view is a top-down shot of the relay's base, showing the internal contact assembly and terminal pins.</p>	<p>Features 特点:</p> <ul style="list-style-type: none"> • 6A switching capability 6A 负载切换能力 • matching inrush current 80A, 承受 80A 冲击电流 • Long E-life type available, 长电寿命型可选择 • 1 poles contact 1 组触点 • M-life 10KK cycles, 机械寿命 1000 万次以上。 • UL insulation system UL 绝缘等级: Class F • ROHS comply. 满足 ROHS 要求 • Comply IEC60335-1 available, 可提供满足 IEC60335-1 标准产品 • Socket available 满足插座配套使用 • Clearance distance: >8 mm, and creepage distance: >8 mm. 空间距离大于 8mm, 爬电距离大于 8mm。
--	---

Contact data 触点参数	
Contact arrangement 触点类型	1A/1C 1 组常开型/1 组转换型
Contact resistance 接触电阻	100mΩ max. (at 1A 6VDC) 100mΩ以下 (在 6VDC1A 条件下)
Contact material 触点材料	AgSnO alloy 银氧化锡合金
Contact rating 额定负载	NO: 6A 277VAC, COSΦ =1.0

	<p>NO: 6A 24VDC, L/R=0</p> <p>NC: 6A 277VAC, COSΦ =1.0</p> <p>NC: 6A 24VDC, L/R=0</p>
Max. switching voltage 最大切换电压	277VAC/30VDC
Max. switching current 最大切换电流	6A
Max. switching power 最大切换功率	1662VA/180W
Min. switching load 最小切换负载	10mA6V
Mechanical endurance 机械耐久性	10,000,000 cycles min.; 1000 万以上
Electrical endurance 电气耐久性	<p>Standard type 标准型:</p> <p>at ON/OFF=1s/9s, normal temp.通断时间: 1s 通/9s 断, 常温。</p> <p>NO: 6A 250VAC, R-load 阻性负载, 30,000cycles min.</p> <p>NO: 6A 24VDC, R-load 阻性负载, 30,000cycles min.</p> <p>NC: 6A 250VAC, R-load 阻性负载, 10,000cycles min.</p> <p>NC: 6A 24VDC, R-load 阻性负载, 10,000cycles min.</p> <p>Long E-life type 长电寿命型:</p> <p>at ON/OFF=1s/9s, normal temp.通断时间: 1s 通/9s 断, 常温。</p> <p>NO: 6A 250VAC, R-load 阻性负载, 60,000cycles min.</p> <p>NO: 6A 24VDC, R-load 阻性负载, 100,000cycles min.</p> <p>NC: 6A 250VAC, R-load 阻性负载, 30,000cycles min.</p> <p>NC: 6A 24VDC, R-load 阻性负载, 30,000cycles min.</p>

Characteristics (initial)特性参数 (初期)	
Insulation resistance 绝缘电阻	1000MΩ(at 500VDC)
Dielectric strength 介质耐压	Between coil and contacts: 5000V for 1 minute 线圈与触点间: 5000V (1 分钟)
	Between across contacts of same pole: 1000V for 1 minute 断开触点间: 1000V (1 分钟)
Operate time (at normal voltage) 动作时间 (额定电压下)	10ms max. 10ms 以下
Release time (at normal voltage) 释放时间 (额定电压下)	5ms max. 5ms 以下
vibration resistance 振动特性	10Hz-55Hz, at double amplitude 1mm 频率 10Hz-55Hz, 双振幅 1mm
Shock resistance 冲击特性	Functional: Min. 100m/s ² 功能性: 100m/s ² 以上。 Destructive: Min. 1000m/s ² 强度: 1000m/s ² 以上
Ambient temperature 环境温度	-40°C to 85°C
Humidity 环境湿度	5% to 85% RH
Termination 端子结构	PCB type. PCB 安装型
Unit weight 重量	Approx. 5g 大约 5g
Construction 保护结构	Flux protected or plastic sealed type 防焊剂型或塑封型

Standard 标准型: Coil data (DC spec: 0.18W)线圈参数 (DC 规格: 0.18W)					
Rated voltage 线圈额定电压	Coil resistance (Ω) (at 23°C) 线圈电阻	Operate voltage 动作电压 (at 23°C)	release voltage 释放电压 (at 23°C)	Allowable voltage range in coil 线圈容许施加的电压范围 (at 23°C)	Nominal coil power 标称线圈功率 (approx. W)
		% of rated voltage 额定电压对的百分比			
3	50×(1±10%)	80%MAX.	5%MIN.	95-120%	0.18
5	139×(1±10%)				0.18
6	200×(1±10%)				0.18
9	450×(1±10%)				0.18
12	800×(1±10%)				0.18
15	1250×(1±10%)				0.18
18	1800×(1±10%)				0.18
24	3200×(1±10%)				0.18
36	5180×(1±10%)				0.25
48	9200×(1±10%)				0.25
60	14400×(1±10%)	0.25			

Long E-life type 长寿命型: Coil data (DC spec: 0.4W)线圈参数 (DC 规格: 0.4W)					
Rated voltage 线圈额定电压	Coil resistance (Ω) (at 23°C) 线圈电阻	Operate voltage (at 23°C) 动作电压	release voltage (at 23°C) 释放电压	Allowable voltage range in coil 线圈容许施加的电压范围 (at 23°C)	Nominal coil power 标称线圈功率 (approx. W)
		% of rated voltage 额定电压对的百分比			
3	22.5×(1±10%)	80%MAX.	5%MIN.	95-120%	0.4
5	62.5×(1±10%)				0.4
6	90×(1±10%)				0.4
9	202×(1±10%)				0.4
12	360×(1±10%)				0.4
15	562×(1±10%)				0.4
18	810×(1±10%)				0.4
24	1440×(1±10%)				0.4
36	3240×(1±10%)				0.4
48	5760×(1±10%)				0.4
60	9000×(1±10%)				0.4

Ordering information 订货信息

HHC	41	-	10	-	1H	S	P	F	T	G	-	(XXX)	-	DC12V
1	2		3	-	4	5	6	7	8	9		10		11

- 1.Trademark Code : HHC:C-Lin
- 2.Design Model: 41
- 3.Current Rate: 6:6A; 10:10A
- 4.Contact form: 1H: One set of normally open; 1Z:One set of conversions
- 5.Seal form: S:Sealing (RTIII waterproof); Blank: Standard
- 6.Coil Power Consumption: P:High Power Type; Blank: Standard
- 7.Insulation class: F:Class F
- 8.Contact Material: T:AgNi; Blank: AgSnO₂
- 9.Contact Plating: G:Gilt Blank: Without Gilt
- 10.Customer Code: XXX stands for letters or numbers not related to the structure or blanks
- 11.Coil Voltage:
Standard: 3VDC,5VDC,6VDC,9VDC,12VDC,15VDC,18VDC,24VDC,36VDC,48VDC
High Power Type: 3VDC,5VDC,6VDC,9VDC,12VDC,15VDC,18VDC,24VDC,36VDC,48VDC,60VDC

Outline dimensions 外形尺寸

外形尺寸图 OUTLINE

引出脚垂直安装型 terminal Vertical mounition:

1C TYPE 1组转换型

1A TYPE 1组常开型

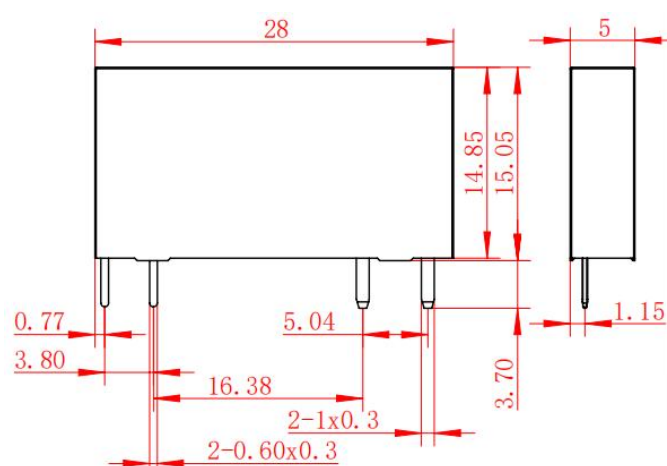
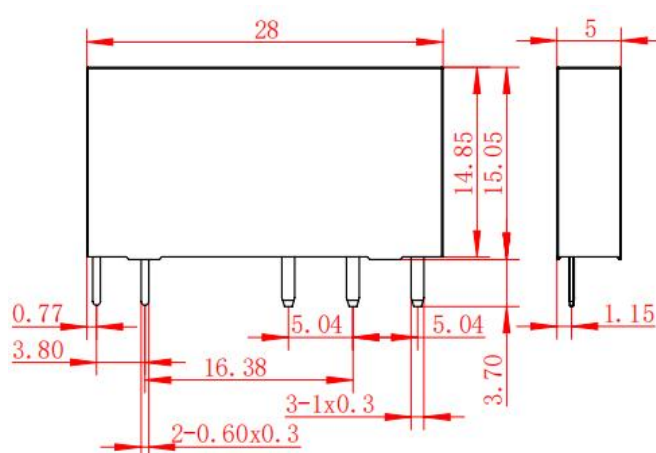

引出脚水平安装型 terminal Flat mounting:

1C TYPE 1组转换型

1A TYPE 1组常开型

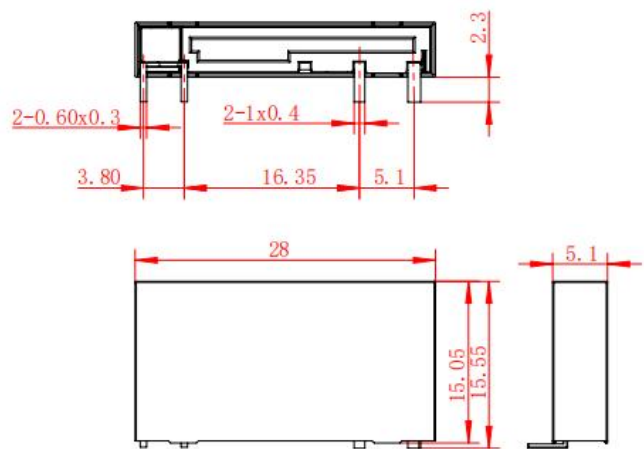
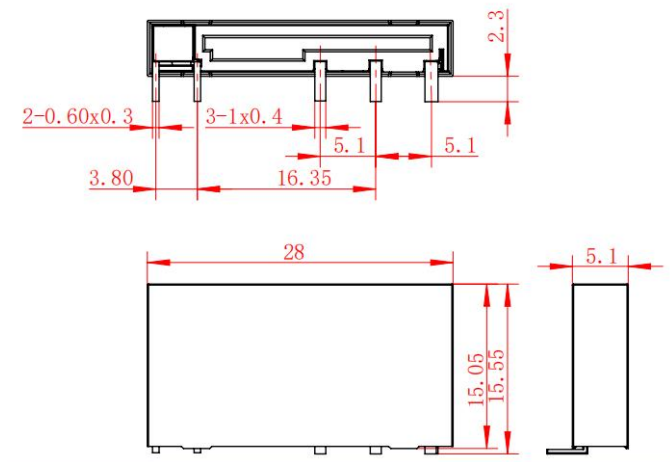

内部接线图 Terminal-arrangement(bottom view)

1C TYPE 1组转换型

1A TYPE 1组常开型



安装孔尺寸图 Mounting dimension(bottom view)

1C TYPE 1组转换型

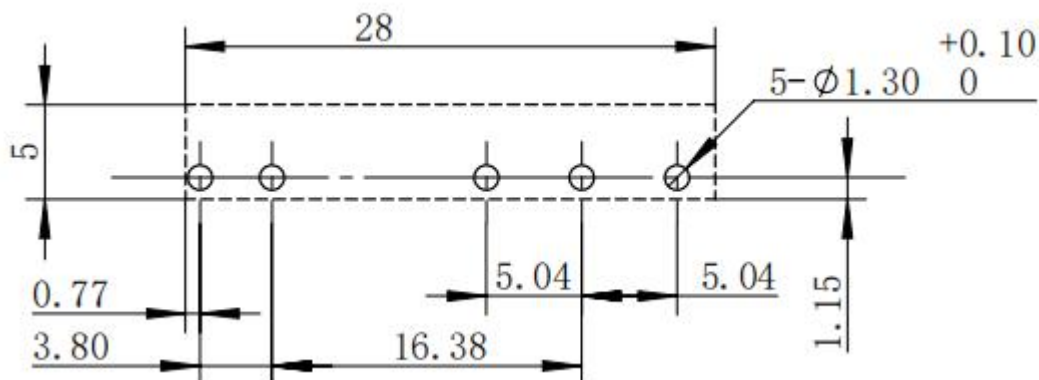

1A TYPE 1组常开型

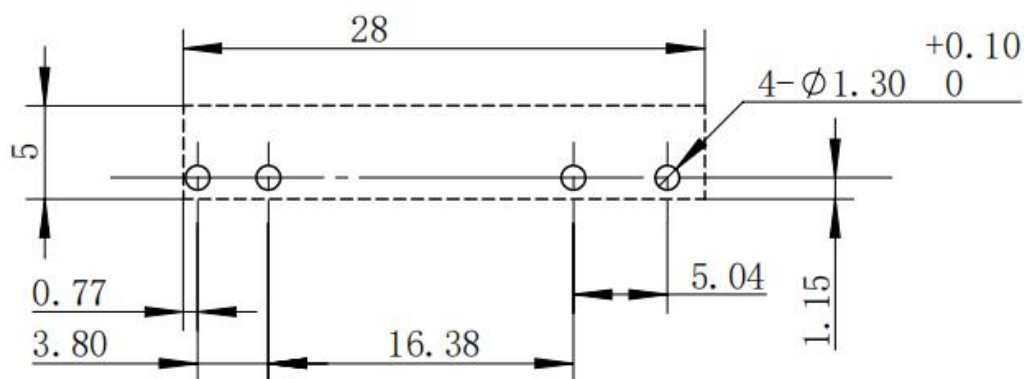
**备注:**

(1) 产品部分外形尺寸未注尺寸公差, 当外形尺寸 $\leq 1\text{mm}$, 公差为 ± 0.1 ; 当外形尺寸在 1-3mm 之间时, 公差为 ± 0.2 ; 当外形尺寸 $> 3\text{mm}$, 公差为 ± 0.3 ;

There are some outline-dimension without tolerance, please refer these: dimension is less than 1mm, tolerance is ± 0.1 ; dimension is 1-3mm, tolerance is ± 0.2 ; dimension is more than 3mm, tolerance is ± 0.3 .

(2) 安装孔尺寸中未注尺寸公差为 ± 0.1 。 the mounting dimension tolerance is ± 0.1 .

声明:

本产品规格书仅供客户使用时参考, 若有更改, 恕不另行通知。 对我司而言, 不可能评定继电器在每个具体应用领域的所有性能参数要求, 因而客户应根据具体的使用条件选择与之相匹配的产品, 若有疑问, 请与我司联系以便获取更多的技术支持, 但产品选型责任仅由客户负责。

The data-sheet is only for reference when customer use, if we have some change, we can not show the notice to you. We can not evaluate all the performance and all the parameters for every application, so that please choose the suitable relay-product in your application. If you have any questions, please connect our company for further supports.