

I. Overview

The HHS13 (ST6P) series time relays (hereinafter referred to as relays) are suitable for use as time - delay elements in control circuits with an alternating current of 50Hz, a working voltage of 380V or less, or a direct - current working voltage of 220V or less. They connect or disconnect the circuit according to the preset time. This series of relays complies with the relevant requirements of GB/T 14048.5.

II. Main Technical Data

Product Model	HHS13 (ST6P - 2, H3Y - 2)	HHS13 - 1 (ST6P - 4, H3Y - 4)
Product Name	Time Relay	
Working Power Supply	AC24V, 36V, 110V, 220V, 380V 50Hz; DC24V, 110V, 220V. The allowable voltage fluctuation range is (85% - 110%) U _e .	
Time - delay Range	1s, 5s, 10s, 30s, 60s, 120s, 180s, 5m, 10m, 30m, 60m, 3h, 5h	
Repeat Error	≤1%	
Working Mode	Power - on Time - delay	
Number of Contacts	2 sets of time - delay change - over contacts	4 sets of time - delay change - over contacts
Contact Capacity	5A AC250V (resistive)	3A AC250V (resistive)
Ambient Temperature	-5°C ~ 40°C	
Altitude	≤2000m	
Humidity	When the maximum temperature at the installation site is 40°C, the relative humidity of the air ≤50%. At lower temperatures, a higher relative humidity is allowed. For example, it can reach 90% at 20°C. Special measures should be taken for occasional condensation due to temperature changes.	
Installation Method	With different bases, it can be installed in a device - type or on a 35mm DIN rail.	

III. Wiring Diagrams

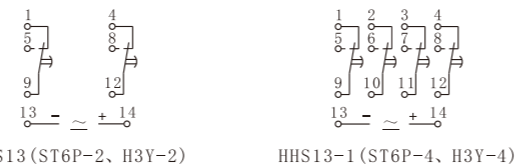

IV. Working Timing Diagrams

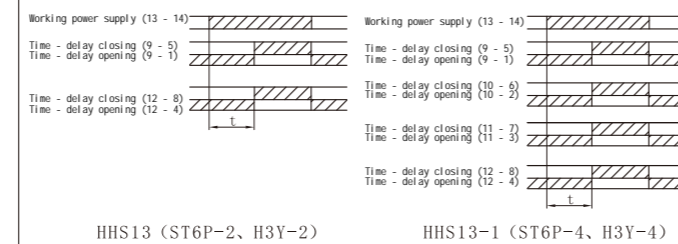

V. Outline Dimension Diagrams (mm)

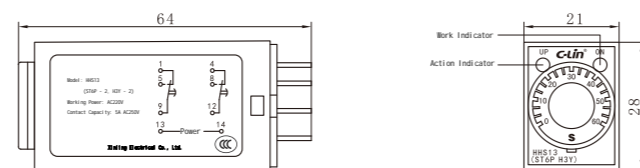

VI. Instructions for Use

1. Refer to the wiring diagram on the relay cover and the circuit examples in Section 8.

connect the product to the control circuit.

2. Adjust the potentiometer to preset the time - delay. Upon power - on, the relay will operate in accordance with the corresponding working sequence specified in Section IV.

3. Since the product's set time is determined by a potentiometer (which is nonlinear), when selecting a time - delay specification, users should choose within the range of 2/3 of the nominal value to the maximum value. Avoid using a large time - delay specification to set a small time - delay, as this may lead to significant time deviations.

4. The interval between repeated startups of the relay should be ≥ 0.5s.

VII. Installation and Removal Methods

- Device - type installation: (1) (2) (3)
- Device - type removal: (4) (5) (6)
- Rail - type installation: (7) (8) (9)
- Rail - type removal: (10) (11) (12)

Note: The main circuit power supply must be cut off before installation or removal.

Note: The base required for installation needs to be purchased separately by the user. The base model for HHS13 is PYF08A, and for HHS13 - 1, it is PYF14A.

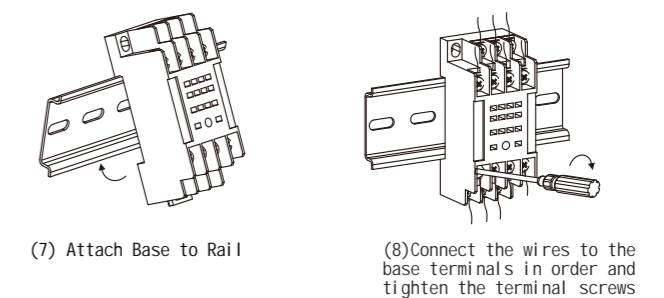
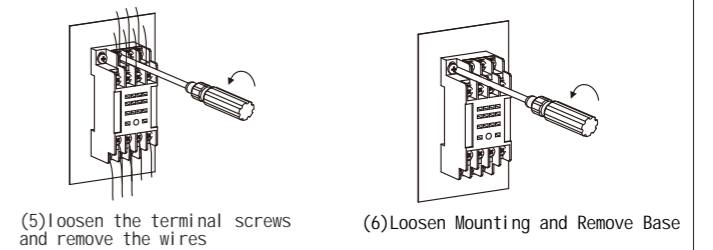
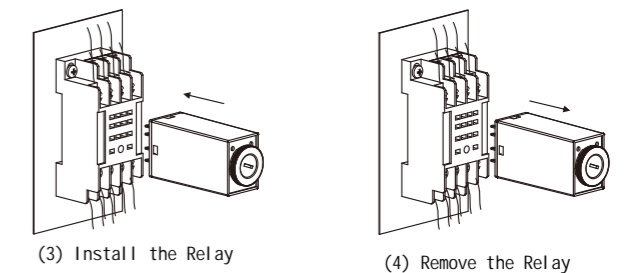
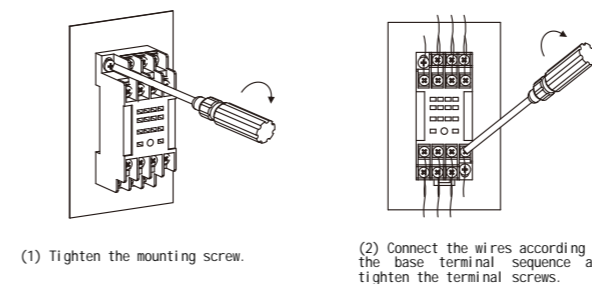

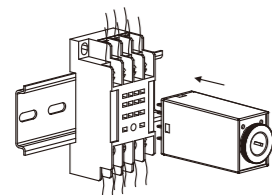

(9) Install the Relay

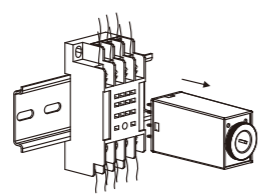

(10) Remove the Relay

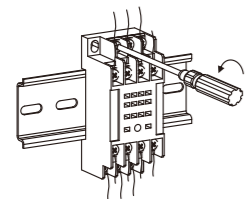

(11) Loosen the terminal screws and remove the connected wires

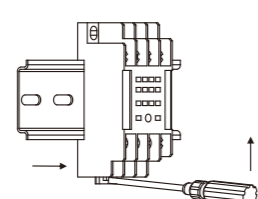

(12) Pry Open Rail Clip and Remove Base

VIII. Application Circuit Examples (Taking HHS13 - 1 (ST6P - 4, H3Y - 4) as an Example)

Example 1:

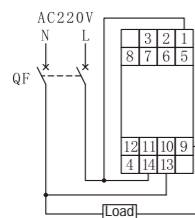

Example 2:

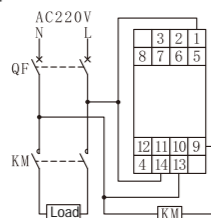

Example 3:

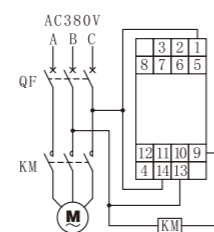

Example 4:

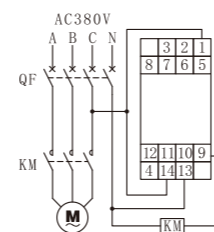

1. Single - phase Loads: Direct Control (3A resistive current or 0.5A inductive current): Refer to Example 1 (the relay directly controls the load). Contactor - Assisted Control (>3A resistive current or >0.5A inductive current): Refer to Example 2 (the relay controls an AC contactor to expand capacity for the load). Three - phase Loads: AC380V Power for Contactor and Relay: Refer to Example 3. AC220V Power for Contactor and Relay: Refer to Example 4 (adjust the wiring according to the actual voltage level; Example 4 here uses AC380V with a neutral wire, and it should be modified for AC220V as required).

2. Relay Function Description: When the power is connected, the load or the AC contactor (KM) is energized. When the preset time - delay value is reached, the load or KM is de - energized (time - delay power - off function).

Note 1: The load, such as a street lamp or a bulb, can be directly connected to the two wires at the lamp port (as shown in Example 1).

Note 2: The coil (A1, A2) of the AC contactor (KM) can be wired according to Examples 2, 3, and 4. Note 3: In Example 3, both the relay and KM operate with AC380V. Pay attention to the voltage level of the selected product.

IX. Ordering Information

Required Information: Specify the product model, voltage level, time - delay range, and quantity. If there are special requirements, they should be noted separately.

Example Order: HHS13 (ST6P - 2, H3Y - 2) AC220V 180s 100 pieces.

C-Lin
欣灵电气股份有限公司
XINLING ELECTRICAL CO., LTD.

地址: 浙江省乐清经济开发区纬十九路328号
电话: 0577-6273 5555 传真: 0577-6272 2963
Http://www.c-lin.cn E-mail: xl@xinling.com
技术咨询: 0577-62731208



国家高新技术企业 浙江省知名品牌

C-Lin 欣灵

使用说明书
Products Instructions

HHS13 (ST6P) Series
Time Relays

Thank you very much for using C-Lin brand time relays. Please read the instruction manual before use!

01A042E6